

DISTRICT	COUNTY	ROUTE	SECTION	SHEET
8-0	LEBANON	2001	013	1 OF 1
		T-669		
		T-705		
NORTH CORNWALL & SOUTH LEBANON TOWNSHIPS AND CITY OF LEBANON				
REVISION NUMBER	REVISIONS	DATE	BY	

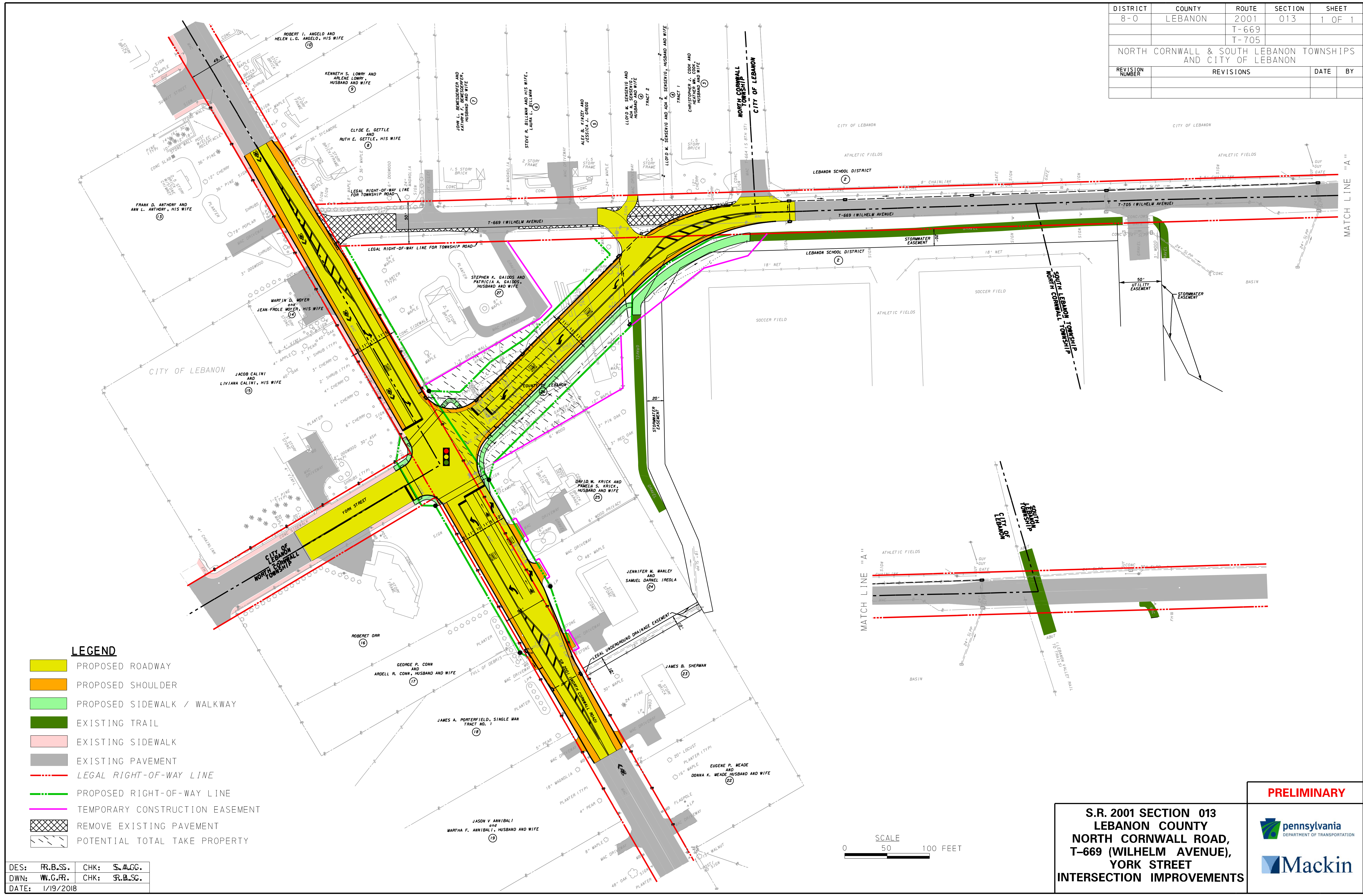

LEGEND

- PROPOSED ROADWAY
- PROPOSED SHOULDER
- PROPOSED SIDEWALK / WALKWAY
- EXISTING TRAIL
- EXISTING SIDEWALK
- EXISTING PAVEMENT
- LEGAL RIGHT-OF-WAY LINE
- PROPOSED RIGHT-OF-WAY LINE
- TEMPORARY CONSTRUCTION EASEMENT
- REMOVE EXISTING PAVEMENT
- POTENTIAL TOTAL TAKE PROPERTY

DES:	RR.B.SS.	CHK:	S.M.CC.
DWN:	WL.G.FR.	CHK:	FR.B.SC.
DATE:	1/19/2018		

SCALE
0 50 100 FEET

**S.R. 2001 SECTION 013
LEBANON COUNTY
NORTH CORNWALL ROAD,
T-669 (WILHELM AVENUE),
YORK STREET
INTERSECTION IMPROVEMENTS**

PRELIMINARY



FILE NAME: G:\4925014\Hwy\Plan Display\SR 2001\Public Plan Display.dgn